

# EXBC BAG FILTER

## PRODUCT INFORMATION

EXBC bag filter housing is a result of our long time experience in filtration and cooperation with Paint Industry.

It has most advanced design optimised for:

- minimum product loss realised by minimum hold up
- efficient filtration realised by positive bag sealing
- easy changing of filterbags
- purity: no more dripping paint around installation.



It's robust design, selection of materials of constructions and finishes make it ideal for most demanding applications. It accepts all standard filterbags with metal ring or plastic self sealing collar, size 2 (7"/32") or 1 (7"/16").

It is designed and manufactured according to EEC directive PED 97/23/EC for group 1 liquids and has a CE marking. It can be used for filtration of "dangerous liquid substances" as understood by this directive and compromises most common process streams. Standard design pressure is 10 bars at T=100°C.

EXBC housings can be executed in two basic finishes: industrial: glass beaded (satin), and with mirror polish finish for more demanding applications where

cleanness and easy cleaning of a housing is essential. Standard construction materials are AISI 304 and AISI 316L.

## PRODUCT MAIN FEATURES

- ❑ Two basic orientations available:
  - conventional
  - angled
- ❑ Construction materials:
  - AISI 304
  - AISI316L
- ❑ Finishes:
  - mirror polish
  - satin: glass beaded
- ❑ Pressure ratings:
  - 10 bars
  - 16 bars.
- ❑ Wide selection of connections:
  - Threaded
  - Flanged
  - Tri Claver or DIN quick coupling
  - Camlock
- ❑ Swing bolt closure with minimum hold up volume
- ❑ Easy change out of bags.

## STANDARD PARAMETERS

**P<sub>max</sub>=10 bar**

**T<sub>max</sub>=100°C**

### AVAILABLE CONNECTIONS:

- threaded
- flanged
- DIN quick couplings
- TC sanitary flange
- butt weld

# ORDERING INFORMATION

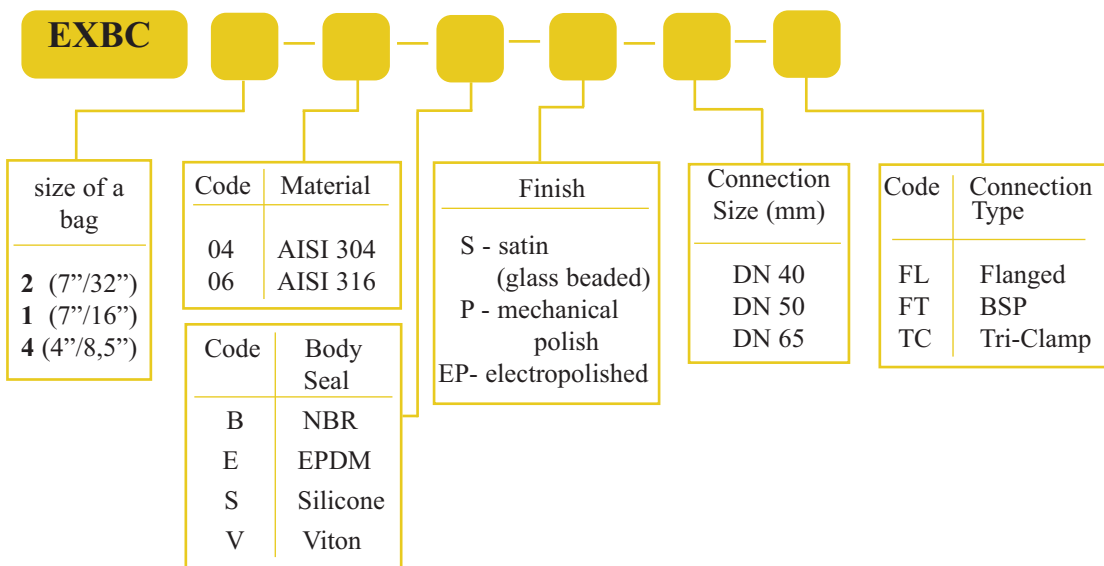

housing with heating jacket



mirror polish execution



polylock design

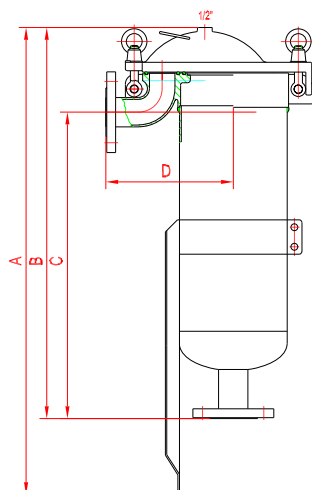

TYP	A		B	C	D
	Max.	Min.			
EXBC1	847	723	628	455	260
EXBC2	1217	998	998	825	260
EXBC4	611	488	488	354	150